



# User Installation Guide

## Topaz SigPlusExtLite

Designed for use in Chrome, Firefox, Edge, and Opera  
Browser Extension frameworks.

**Version 2.0 R1053**

Copyright © 2020 Topaz Systems Inc. All rights reserved.

For Topaz Systems, Inc. trademarks and patents, visit [www.topazsystems.com/legal](http://www.topazsystems.com/legal).

## Table of Contents

<b>1.0 – Introduction.....</b>	<b>3</b>
<b>2.0 – Browsers and Operating Systems Supported.....</b>	<b>3</b>
<b>3.0 – Installation Steps .....</b>	<b>3</b>
3.1 – Installing SigPlus and the Topaz SigPlusExtLite SDK.....	3
3.2 – Installing Topaz SigPlusExtLite Browser Extensions.....	4
<b>3.2.1 – Google Chrome.....</b>	<b>4</b>
<b>3.2.2 – Mozilla Firefox.....</b>	<b>6</b>
<b>3.2.3 – Microsoft Edge (Chromium) .....</b>	<b>8</b>
<b>3.2.4 – Opera .....</b>	<b>10</b>
3.3 – Run the Sample Web Page .....	14

## 1.0 – Introduction

With Topaz SigPlusExtLite, you can capture handwritten signatures securely in Google Chrome, Mozilla Firefox, Opera, and Microsoft Edge (Chromium) browsers using Topaz Signature Pads and GemView Devices. This document provides instructions on installing Topaz SigPlusExtLite.

## 2.0 – Browsers and Operating Systems Supported

Topaz SigPlusExtLite SDK can be integrated into web pages running versions of the Google Chrome 77, Mozilla Firefox 68, Opera 68 and Microsoft Edge (Chromium) 80 browser, and later, as installed on Windows 7, and later, 32-bit and 64-bit operating systems.

**Note:** .NET Framework 4.7.1 or higher should be available in the end user's Windows computer.

## 3.0 – Installation Steps

**Before installing SigPlusExtLite be sure to uninstall any previous versions of SigPlusExtLite.**

### 3.1 – Installing SigPlus and the Topaz SigPlusExtLite SDK

Before the extensions are installed, the Topaz SigPlusExtLite SDK and the SigPlus ActiveX control must be installed. To install on your computer, follow these steps:

1. Uninstall any previous versions of SigPlusExtLite.
2. Download and install SigPlus for your device:
  - a. For Topaz Signature Pads, see: [www.sigpluspro.com](http://www.sigpluspro.com).
  - b. For GemView Tablet Displays, see: [www.topazsystems.com/Software/SigPlusOCXWin32\\_GVA.msi](http://www.topazsystems.com/Software/SigPlusOCXWin32_GVA.msi). Additional Topaz GemView Driver software should be downloaded and installed from the “GemView Drivers” section: [www.topazsystems.com/software.html?tab=gemview-software-tab](http://www.topazsystems.com/software.html?tab=gemview-software-tab).
3. Download and save Topaz SigPlusExtLite to your computer's desktop from the following URL: <https://www.topazsystems.com/Software/SigPlusExtLite.exe>.
4. Right-click on the “TopazSigPlusExtLite.exe” installer and choose “Run as Administrator”. Then, follow the steps in the setup wizard.

## 3.2 – Installing Topaz SigPlusExtLite Browser Extensions

### 3.2.1 – Google Chrome

1. Start the Chrome Browser. Go to the Topaz “SigPlusExtLite” Background Extension page by navigating to the following URL:  
<https://chrome.google.com/webstore/detail/topaz-sigplusextlite-back/dhcbobccjkdnmibckgpejmbpmpembgco>

**Note:** In case clicking the URL does not work, try copy and pasting the URL in the Chrome browser.

2. Click the “Add to Chrome” button displayed on the top right of the page that is displayed (see the screenshot below).

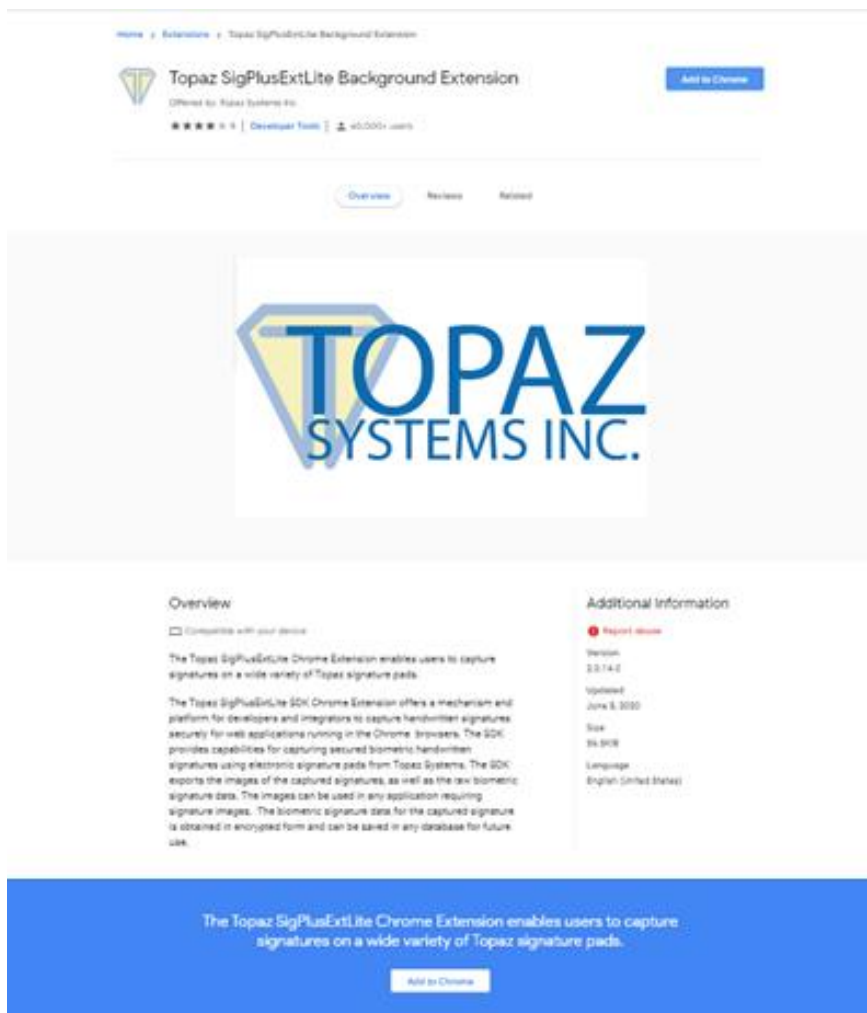

3. Click on the “Add extension” button in the confirmation dialog that is displayed.

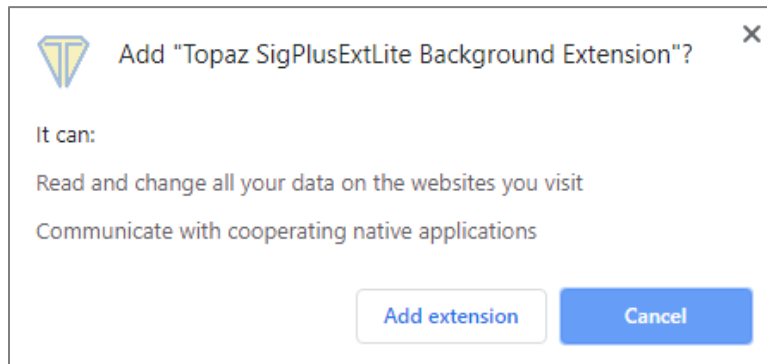

## 3.2.2 – Mozilla Firefox

Before installing the Firefox extension, it is advised to remove any previous version of the extension from the Firefox Add-ons manager page, Extension section. After removing the older version follow these steps to install the new extension:

1. Go to the Topaz “SigPlusExtLite” Background Extension page by navigating to the following URL: <https://addons.mozilla.org/en-US/firefox/addon/topaz-sigplusextlite-extension/>.

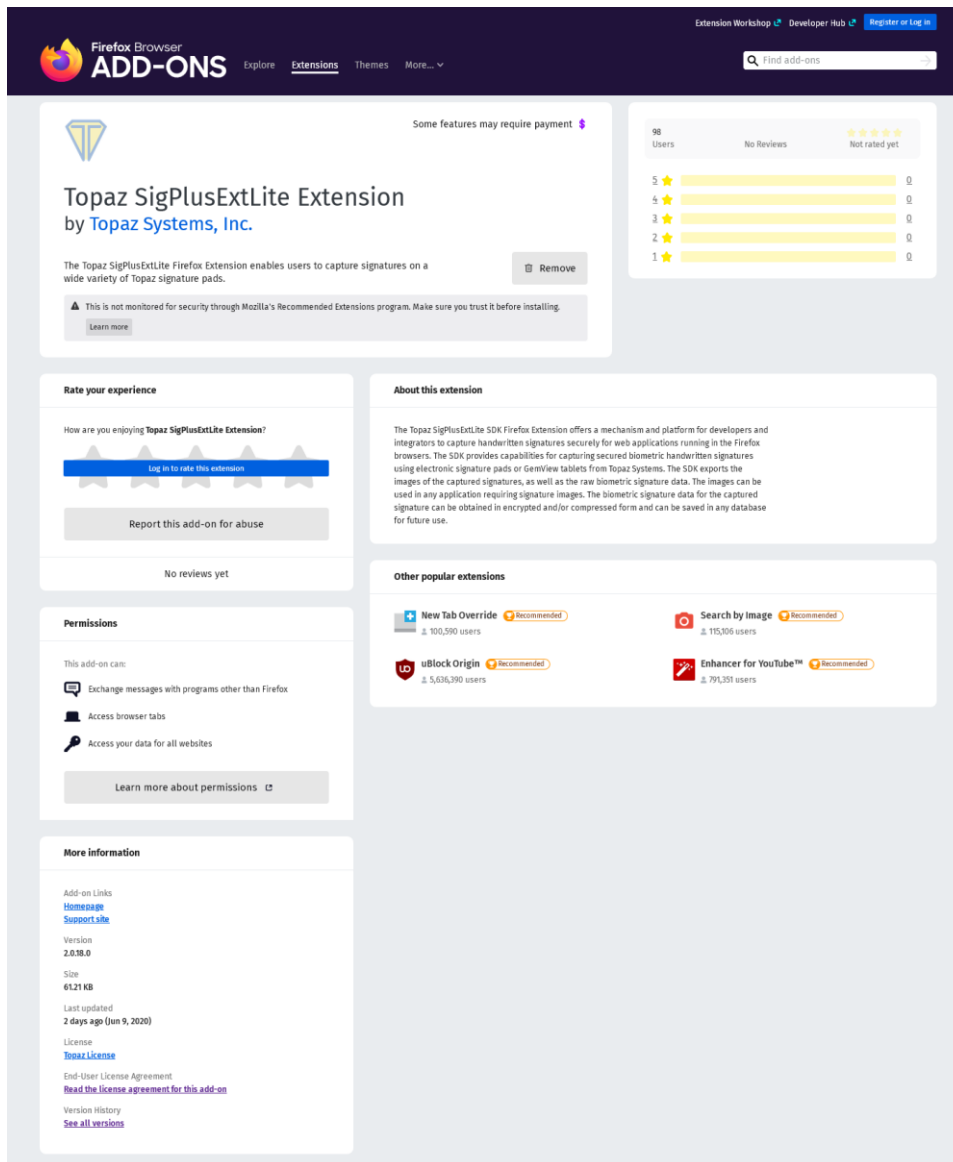

2. In the window that appears, click add to install the addon: Click “Okay, Got it” to complete the install.

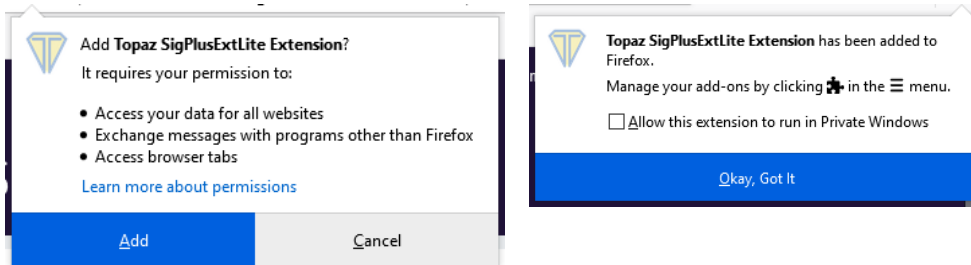

*Note:*

- *Step 2 has to be performed for all the Windows login accounts by logging into Windows and starting the Firefox browser.*

### 3.2.3 – Microsoft Edge (Chromium)

Microsoft Edge has adopted the Chromium open source project. It now supports installation of Chrome Extensions, and SigPlusExtLite leverages the Chrome Extension to capture signatures in the Microsoft Edge browser. Follow the following steps to install the Chrome extension in the Microsoft Edge browser.

1. Start the Microsoft Edge (Chromium) Browser.
2. Go to the Topaz “SigPlusExtLite” Background Extension page by navigating to the URL:  
<https://chrome.google.com/webstore/detail/topaz-sigplusextlite-back/dhcbobccjkdnmibckgpejmbpmpembgco>

**Note:** In case clicking the URL does not work, try copy pasting the URL in the Edge browser.

3. A window showing the Chrome Extension similar to the one in [Section 3.2.1](#) will be displayed. Click the “Add to Chrome” button displayed on the top right of the page (see the screenshot below).



You can now add extensions from the Chrome Web Store to Microsoft Edge - Click on 'Add to Chrome'.

chrome web store Sign in

Home > Extensions > Topaz SigPlusExtLite Background Extension

**Topaz SigPlusExtLite Background Extension** [Add to Chrome](#)

Offered by: Topaz Systems Inc

★★★★☆ 8 | [Developer Tools](#) | 60,000+ users

[Overview](#) [Reviews](#) [Related](#)

**Overview**

Compatible with your device

The Topaz SigPlusExtLite Chrome Extension enables users to capture signatures on a wide variety of Topaz signature pads.

The Topaz SigPlusExtLite SDK Chrome Extension offers a mechanism and platform for developers and integrators to capture handwritten signatures securely for web applications running in the Chrome browsers. The SDK provides capabilities for capturing secured biometric handwritten signatures using electronic signature pads from Topaz Systems. The SDK exports the images of the captured signatures, as well as the raw biometric signature data. The images can be used in any application requiring signature images. The biometric signature data for the captured signature is obtained in encrypted form and can be saved in any database for future use.

**Additional Information**

[Report abuse](#)

**Version**  
2.0.14.0

**Updated**  
June 5, 2020

**Size**  
56.5KiB

**Language**  
English (United States)

The Topaz SigPlusExtLite Chrome Extension enables users to capture signatures on a wide variety of Topaz signature pads.

[Add to Chrome](#)

- Click on the “Add extension” button in the confirmation dialog that is displayed.

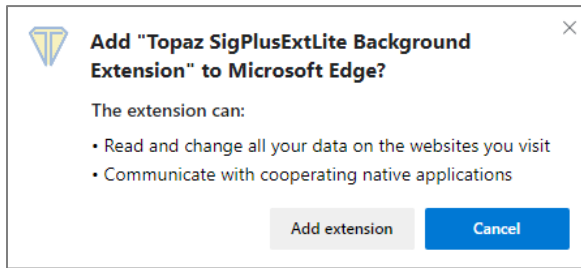

### 3.2.4 – Opera

Opera supports the installation of Chrome Extensions from the Chrome store. Topaz SigPlusExtLite leverages the Chrome Extension to capture signatures in the Opera web browser. Follow the following steps to install the Chrome extension in the Opera web browser.

- Start the Opera Browser.
- Go to the Opera Add-ons page and install “Install Chrome Extensions” Add-on by navigating to the following URL:  
<https://addons.opera.com/en/extensions/details/download-chrome-extension-9/?display=en>
- Click the “+ Add to Opera” button displayed on the top right of the page (see the screenshot below).

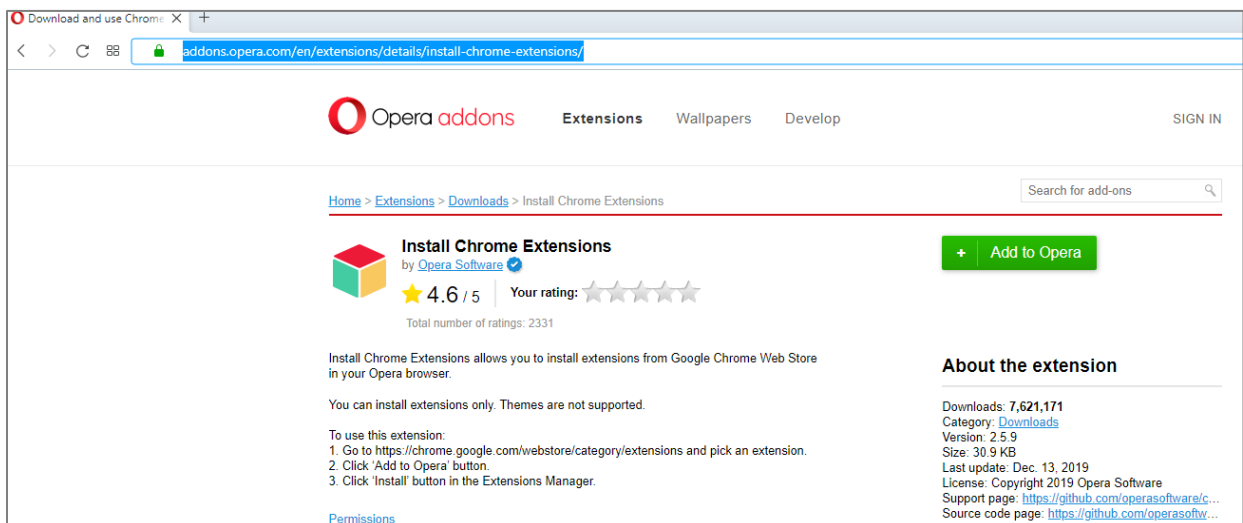

- To view the installed extension type Ctrl+Shift+E or enable the extensions to be viewed in the sidebar: Settings > Sidebar > Manage sidebar > Enable Extensions (see the screenshot below).

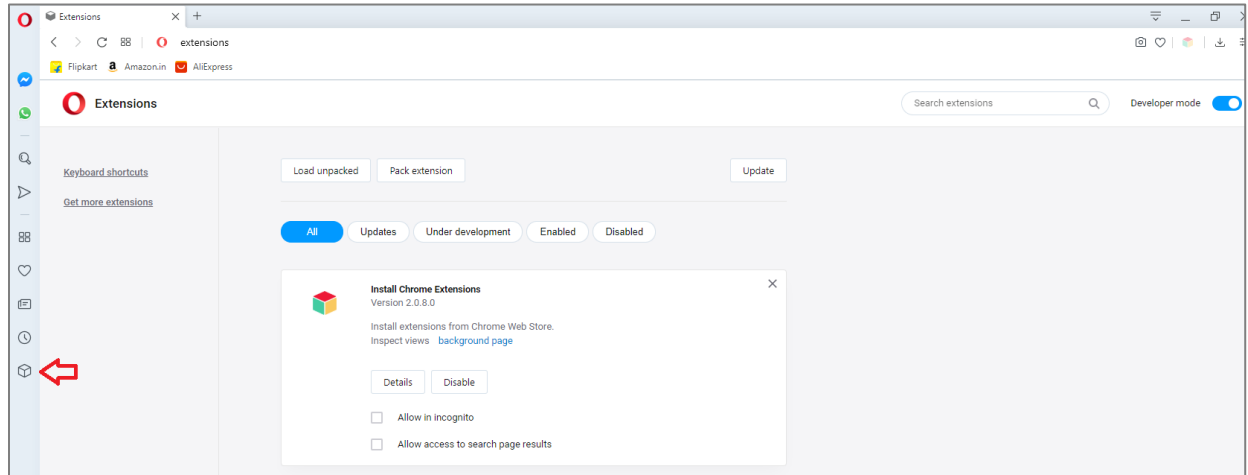

5. Go to the Topaz “SigPlusExtLite” Background Extension page on the Chrome web store by navigating to the following URL:  
<https://chrome.google.com/webstore/detail/topaz-sigplusextlite-back/dhcpobccjkdnmibckgpejmbpmpembgco>

**Note:** In case clicking the URL does not work, try copying and pasting the URL in the Opera browser.

6. Click on the “Add to Opera” button displayed on the top right of the page that is displayed (see the screenshot below).

chrome web store Sign In

Home > Extensions > Topaz SigPlusExtLite Background Extension

**Topaz SigPlusExtLite Background Extension** Add to Opera

Offered by: Topaz Systems Inc

★★★★★ 8 | [Developer Tools](#) | 60,000+ users

Overview | Reviews | Related

### Overview

Compatible with your device

The Topaz SigPlusExtLite Chrome Extension enables users to capture signatures on a wide variety of Topaz signature pads.

The Topaz SigPlusExtLite SDK Chrome Extension offers a mechanism and platform for developers and integrators to capture handwritten signatures securely for web applications running in the Chrome browsers. The SDK provides capabilities for capturing secured biometric handwritten signatures using electronic signature pads from Topaz Systems. The SDK exports the images of the captured signatures, as well as the raw biometric signature data. The images can be used in any application requiring signature images. The biometric signature data for the captured signature is obtained in encrypted form and can be saved in any database for future use.

### Additional Information

[Report abuse](#)

**Version**  
2.0.14.0

**Updated**  
June 5, 2020

**Size**  
56.5KiB

**Language**  
English (United States)

The Topaz SigPlusExtLite Chrome Extension enables users to capture signatures on a wide variety of Topaz signature pads.

Add to Opera

7. Click OK in the “Install Chrome Extensions” dialog that is displayed.

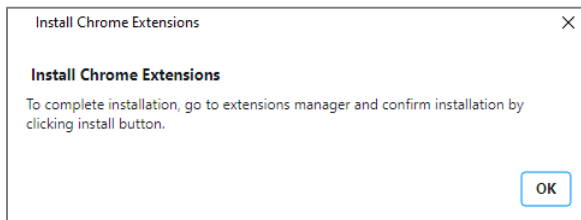

- Click on the “Install” button on the top right of the displayed page to install and enable the extension (see the screenshot below).

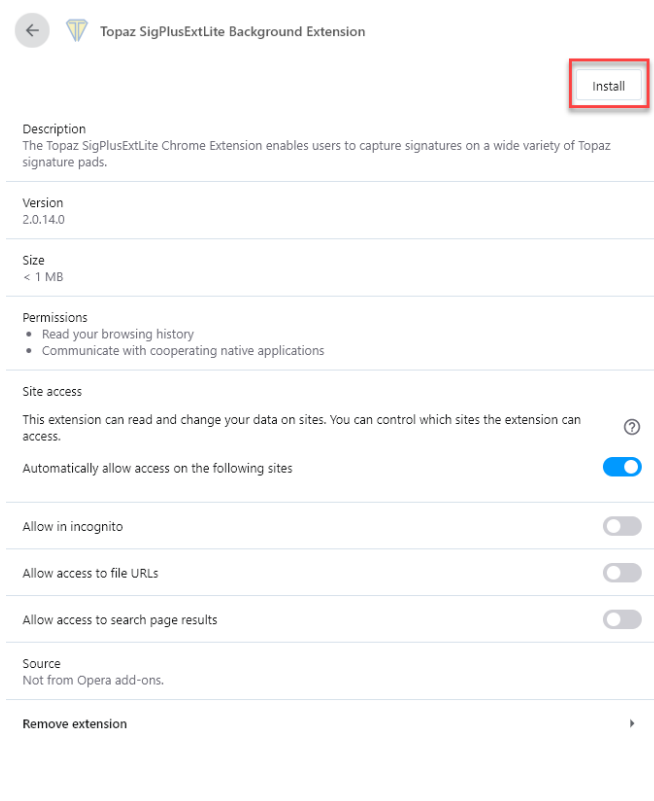

- Finally, click on the “Yes, install” button in the confirmation dialog that is displayed (see the screenshot below).

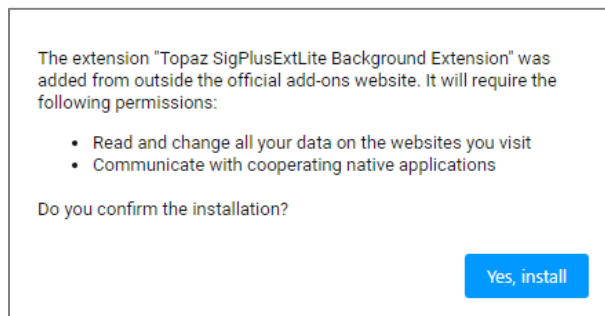

### 3.3 – Run the Sample Web Page

After the SigPlusExtLite software (SDK and Extensions) is installed and the Topaz Signature Pad or the GemView Device is connected to the client PC, launch Google Chrome, Mozilla Firefox, Opera or Microsoft Edge (Chromium) browser and navigate to the following pages:

- Sample 1 (For GemView Devices & Topaz Signature Pads):  
[https://sigplusweb.com/sign\\_chrome\\_ff\\_sigplusextlite.html](https://sigplusweb.com/sign_chrome_ff_sigplusextlite.html)
- Sample 2 (For GemView Devices):  
[https://www.sigplusweb.com/SigPlusExtLite\\_Demo/sample1/SigPlusExtLiteDemo.html](https://www.sigplusweb.com/SigPlusExtLite_Demo/sample1/SigPlusExtLiteDemo.html)

Click the “Sign” button, and the signing window will appear as shown. Sign on your signature pad. To accept the signature, click the green checkmark icon. To clear the signing window and re-sign, click the blue clear icon. To cancel, click the red cancel icon.

